

FOTO WALSER
SPEZIALVERSAND

Gewerbering 26
86666 Burgheim
Tel. +49 84 32 / 9489-0
Fax. +49 84 32 / 9489 - 8333
eMail: info@foto-walser.de
www.foto-walser.de

walimex^{pro}

Copy of Instruction Manual



Studio Flash
Series VC-200 bis VC-1000

Content

1.	How to understand the instruction manual.....	3
1.1.	Markings on the device.....	3
1.2.	Markings in the manual	4
2.	Important safety notes.....	4
3.	Unpack and check the device	7
4.	Operation of the device	8
4.1.	Overview about the parts	8
4.2.	Quick start guide	8
5.	Demount and mount protection cap	9
6.	Mount and demount reflector	10
7.	Screw in and out of modeling bulb	11
8.	Connect to power supply	13
9.	Switch the device on and off	13
10.	Adjustments	14
10.1.	Adjust flash output.....	14
10.2.	Adjust the modeling lamp depending on flash output	15
10.3.	Adjust the modeling lamp independent from flash output.....	16
10.4.	Switch the acoustic beeper button on and off	16
10.5.	Prepare and adjust flash trigger.....	17
	Prepare flash trigger through camera	
	Prepare flash trigger through remote receiver (optional)	
	Switch on and off of flash trigger through build-in photo cell	
	Switch on, adjust and switch off of pre-flash suppression	
11.	Mount on tripod (optional)	19
12.	Mount reflex umbrella (optional).....	20
13.	Switch on and off of modeling lamp	20
14.	Flash trigger	21
15.	Transportation and storage.....	22
16.	Solve problems	23
17.	Maintenance	24
17.1.	Continuous inspections.....	24
17.2.	Cleaning.....	24
17.3.	Change flash tube	25
17.4.	Change micro-fuse	27
17.5.	Charge of flash capacitor	28
18.	Accessories and options	29
19.	Spare parts	29
20.	Disposal and environment protection.....	29
21.	Technical specifications.....	30
22.	Overview about operation panel	31
22.1.	Overview about the function of operating controls	32

Thank you very much for your confidence. We wish you much pleasure and success with your studio flash.

The walimex pro studio flash series VC is especially developed for ambitious beginners and professional users.

The VC series is perfectly suitable for studio, portrait, person, nude and product photography.

The main features of your device as follows:

- fast recycling time and quick flash sequences
- acoustic overheating and overloading warning
- very quiet cooling
- user friendly operation panel with foil knobs
- variation range from 1/1 to 1/16.



- **Please read these instructions carefully before using your device for the first time. It includes everything you need to know to avoid physical injuries and damages.**
- **Please pay attention to all safety notes in this instruction manual.**
- **Please keep this manual safe. In case of selling or leaving the device to other persons, please don't forget to hand this manual over as well.**

1. How to understand the instruction manual

1.1. Markings on the device



This marking mean, that your device meets the safety requirements of all relevant European Directives.



This marking mean, that your device should be disposed in the local disposal points.

1.2. Markings in the manual

Marking	Meaning
	Indicates the handling and consequences of safety notes.
WARNING	Indicates a hazardous situation, which, if not avoided, could result in a serious injury or death .
CAUTION	Indicates a hazardous situation, which, if not avoided, may result in minor or moderate injury.
<i>ADVICE:</i>	Indicates potentially physical damages and other important information in connection with your device.

2. Important safety notes



Risk of retina damage

The flash light could damage your retina up to the loss of vision, if your flash is triggered in close distance to persons or animals.

- **Please don't trigger a flash in close distance to the eyes of persons or animals.**

Please make sure, that the distance between persons and animals is at least 2m. Please avoid looking into the flash directly.

⚠ WARNING

Danger of crashing, entrapment, burning and fire through the falling down of the device.

The weight of the flash is, depending on the model (VC-200 to VC-1000), up to 3,3kg. The modeling lamp, flash tube and reflector could heat up up to 240°C.

- Make sure, that the device is always positioned tilt and skid resistant and stored securely.
- Keep out of reach of children and animal. They could overturn the device.
- Avoid placing cables where they can be tripped over. The device could be overturned.

⚠ WARNING

Danger of electric shock, burn hazard

Please note, that the device is still connected with the supply voltage even if it is switched off. Just after disconnecting the device from the power supply through pulling out the power cable, the device is actually de-energized.

- Switch off your device when it is not in use.
- Switch off your device before mounting and maintenance and disconnect from power supply.
- Protect your device against unintended switching-on.
- Unplug the power cord, if the flash is not in use for a long time.

⚠ WARNING

Danger of electric shock, fire through short-circuit

A short-circuit could be caused through defect cables and through humidity or moisture. A short-circuit can warm up the conductors, so that there isolation will melt or even melt thoroughly. This could lead to fire.

- Please just use the original cables, which are included in delivery. They are aligned for your device and guarantee the necessary safety for you and your device.
- Don't operate the device with wet hand or feet.
- Operate the device only in dry rooms.
- Don't operate the device outdoors.

- Please only follow this instruction manual for cleaning your device.
- Make sure, that cables and conductors won't be damaged. Damages could be caused through heat impact, chemical influence or through mechanical impacts as rubbing, bending, tearing, rolling over or nibbling animals.
- Prevent your device for falling-off.
In case of falling-off, please let an electrician check the device before switching on again.
- If your device should be damaged or defect or if you notice a burning smell:
Disconnect the power supply by pulling out the power cord. Never operate your device with damaged housing, damaged reflector, defect modeling lamp, defect flash tube or damaged power cord. Don't open the device. Never repair the device on your own. The device should only be repaired by electricians.
- Please follow this instruction manual for maintaining your device.
- Please just use spare parts, which are conform to the required specifications. See *Technical Specifications*.

⚠ WARNING

Fire danger through overheating

The device can overheat, if you operate it with mounted protection cap or with covered ventilation slots. The device itself or easily inflammable materials in close distance could catch fire.

- Don't operate the device with mounted protection cap.
- Don't cover the ventilation slots of the device during operation.
- Remove easily inflammable materials.
- Please just use spare parts, which are conform to the required specifications. See *Technical Specifications*.

⚠ WARNING

Fire danger through hot parts

The modeling lamp and flash tube could heat up up to 240°C, the reflector up to 75°C and the flash housing up to 45°C. Easily inflammable materials could catch fire, if they get in contact with hot parts.

- Don't cover the ventilation slots of the device during operation.
- Remove easily inflammable materials.

⚠ WARNING

Danger of burning on hot parts

The modeling lamp and flash tube could heat up up to 240°C, the reflector up to 75°C and the flash housing up to 45°C.

- Don't touch the parts during operation and cooling down.
- Please cool down your device approx. 30 minutes before starting any mounting or maintenance arrangements.

⚠ WARNING

Danger of cutting and splitting through breaking modeling lamp and breaking or bursting flash tube.

Even small residues of skin oil on the flash tube could lead, due to the high heat impact, to the splitting of the flash tube. Broken glass could hurt eyes and skin.

- Please handle the modeling lamp and flash tube with care to avoid bursting.
- Don't touch the flash tube with bare hands. Wear clean cotton gloves or use a clean cloth.
- Avoid touching the flash tube accidentally when mounting or changing accessories.

3. Unpack and check the device

1. Please unpack your device carefully.
ADVICE: Keep the styrofoam packing for future storage and transportation of the device.
2. Please check, if the delivery is complete:
 - 1 VC Studio Flash with protection cap
 - 1 Reflector
 - 1 Modeling Lamp

- 1 Sync Cord
- 1 Power Cord
- 1 Instruction Manual.

3. Please check, if the delivery is undamaged.

ADVICE: If the delivery should be uncomplete or damaged, please contact info@foto-walser.de or our service hotline with the telephone number +49 843294890.

4. Operation of the device

4.1. Overview about the parts



- A Reflector
- B Unlocking Lever
- C Photo Cell (hidden)
The Photo Cell is below the red, transparent cover on the top side of the device
- D Ventilation Slots
- E Tripod Mounting
- F Umbrella Holder
- G Handle

4.2. Quick start guide

ADVICE:

The detailed instruction for the following operations can be found in the respective chapters in this instruction manual.

Keep the sequences of the following operation steps when using the device for the first time to avoid damages on the device.

4.3. ⚠ WARNING

Please note the safety notes in the respective chapters throughout operation.

1. Demount protection cap.
2. Mount reflector.
3. Insert modeling lamp.
4. Mount umbrella (optional).
5. Connect to power supply.
6. Switch on device.
7. Adjust modeling lamp.
8. Adjust flash output.
9. Adjust acoustic beeper button.
10. Prepare flash trigger.
11. Mount on tripod (optional).

5. Demount and mount protection cap

⚠ WARNING

Posterior danger of bursting of flash tube

Make sure not to touch the flash tube with bare hands accidentally.



A Openings for reflector or protection cap

1. Demounting of protection cap:

- Remove safety cap from unlocking lever.
- Push back unlocking lever and keep pressed.
- Turn protection cap anticlockwise as far as it will go and take off from the device.
- Release the unlocking lever.

2. Mounting of protection cap:

- Cool down the device.
⚠ **WARNING!** Fire danger through overheating. Danger of burning. Let the device cool down for approx. 30 minutes.
- Push back unlocking lever and keep pressed.
- Plug in the protection cap into the three openings on the device, turn it clockwise and listen for the cap to snap into place.
- Trigger the unlocking lever.
- Stick the safety cap onto the unlocking lever.

6. Mount and demount reflector

⚠ WARNING

Posterior danger of bursting of flash tube

Make sure not to touch the flash tube with bare hands accidentally.



A Openings for reflector or protection cap

1. Mounting of reflector:

- Switch off device.
See *Switch the device on and off.*
- Cool down the device.
▲ WARNING! Danger of burning on reflector, modeling lamp and flash tube. Please cool down approx. 30 minutes.
- Demount protection cap.
See *Demount and mount protection cap.*
- Push back unlocking lever and keep pressed.
- Plug the reflector into the openings, so that the opening for the umbrella (optional) faces downwards.
- Turn reflector clockwise and listen for the reflector to snap into place.
- Release the unlocking lever.
- Stick the safety cap onto the unlocking lever.

2. Demount reflector:

- **▲ WARNING!** Danger of burning on reflector, modeling lamp and flash tube. Please cool down approx. 30 minutes.
- Remove safety cap from unlocking lever.
- Push back unlocking lever and keep pressed.
- Turn reflector anticlockwise as far as it will go and take off from the device.
- Mount protection cap.
See *Demount and mount protection cap.*

7. Screw in and out of modeling bulb

▲ WARNING

Posterior danger of bursting of flash tube

Make sure not to touch the flash tube with bare hands accidentally.

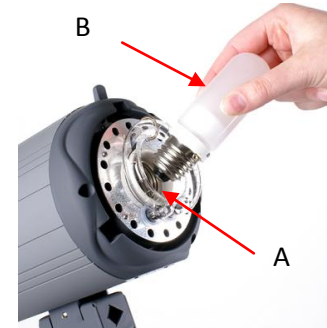

- A Socket
- B Modeling lamp

1. Switch off device.
See *Switch on and off of device.*
2. Plug off power cord.
3. Cool down device.
▲ WARNING! Danger of burning on reflector, modeling lamp and flash tube. Please cool down approx. 30 minutes.
4. Screw in modeling bulb:
 - When the protection cap is mounted:
Demount protection cap.
See *Demount and mount protection cap.*
 - Screw the modeling lamp carefully into the socket.
5. Screw out the modeling bulb:
 - Screw the modeling bulb carefully out of the socket.
 - Demount protection cap.
See *Demount and mount protection cap.*

8. Connect to power supply

6. Switch off device.
See *Switch on and off of device*.
7. Compare the local power supply with the connected load of the device.
If the values differ, please contact info@foto-walser.de or tel. +49 843294890.
8. Connect the power cord with the socket on the device and with the power socket.

9. Switch the device on and off

12. When the protection cap is mounted:

Demount protection cap.

See *Demount and mount protection cap*.

⚠ WARNING! Danger of fire through heat accumulation. Never use the device with mounted protection cap.

13. Switch on device:

Set main switch on I (ON).

- The digital display OUTPUT POWER shows the current adjusted flash output.
- The LED TEST lights up, when the adjusted flash output is reached.
ADVICE: An integrated soft-start prevents the flash tube from damage. It will take 1-2 seconds until the flash output is reached.
- The modeling lamp lights up, if it was switched on, when the device was switched off.
- The LED AUDIO lights up, if the acoustic beeper button was switched on, when the device was switched off.
- LEDs of SLAVE function light up, if photo cell or pre-flash suppression were switched on, when the device was switched off.

14. Switch off device:

Set main switch on O (OFF).

- All signals will go out.

- When the modeling light was switched on:

The modeling lamp will go out.

ADVICE: A special discharging electronics release the residual voltage after switching off. You cannot stop this safety function.

10. Adjustments

10.1. Adjust flash output

You can regulate the power of the flashes according to the below-mentioned chart.

Flash output	
Check value	F-stops
6,0	1 (full power)
5,0	3/4
4,0	1/2
3,0	1/4
2,0	1/8
1,0	1/16

1. Switch on device.
See *Switch on and off of device*.
2. Turn control OUTPUT POWER until the digital display OUTPUT POWER shows the desired output.
When the device reached the adjusted flash output, LED TEST lights up.
3. Trigger test flash:
Press push-button TEST.
The LED TEST goes out and lights up not until the device will reach the adjusted flash output again.

10.2. Adjust the modeling lamp depending on flash output

You can adjust the modeling lamp via 50 values.

1. Switch on device.
See *Switch on and off of device*.
2. Press control OUTPUT POWER once.
 - The modeling lamp switches on.
 - The LED MODEL II lights up.
3. Turn control OUTPUT POWER until the modeling lamp reaches the desired power.
The digital display OUTPUT POWER shows the respective flash output.
4. Switch off modeling lamp:
Press control OUTPUT POWER twice.
 - The modeling lamp switches off.
 - The LED MODEL II goes out.

10.3. Adjustment of modeling lamp independent from flash output

You can adjust the modeling lamp via 50 values.

Switch on device.

See *Switch on and off of device*.

5. Press control OUTPUT POWER twice:
 - The modeling lamp switches on.
 - The LED MODEL I lights up.

6. Press push-button MODEL ▲ or push-button MODEL ▼ until the modeling lamp reaches the desired power.
The digital display OUTPUT POWER shows the current power of the modeling lamp for 1 – 2 s and switches to the flash output automatically.
7. Switch off modeling lamp:
Press control OUTPUT POWER once.
 - The modeling lamp goes out.
 - The LED MODEL I goes out.

10.4. Switch the acoustic beeper button on and off

15. Switch on device.

See *Switch on and off of device*.

8. Switch on acoustic beeper button:
 - Press push-button AUDIO.
The LED AUDIO lights up.
A short beep can be heard when reaching the adjusted flash output.
9. Switch off acoustic beeper button:
Press push-button AUDIO.
 - The LED AUDIO goes out.
 - After releasing a flash, the modeling lamp goes out for a while und lights up again, when the device has reached the adjusted flash output again.
 - A short beep can be heard when reaching the adjusted flash output.

10.5. Prepare and adjust flash trigger

Prepare flash trigger through camera

ADVICE:

Please note the user information of the camera manufacturer for flash synchronisation.

1. Connect sync cord (included in delivery) with the connecting socket on the device.

10. The other end of the sync cord should be connected with the PC jack socket of the camera.

Prepare flash trigger through remote receiver (optional)

ADVICE:

Please note the user information of the remote receiver manufacturer.

1. Connect the cable of the remote receiver with the socket for the sync cord.

Switch on and off of flash trigger through build-in photo cell

The photo cell enables the device to trigger through

- another external device
- IR remote trigger
- On-camera flash devices
- On-camera flash devices with integrated pre-flashes.

1. Switch on device.
See Switching on and off of device.
2. Switch on photo cell:
Press push-button SLAVE.
The LED SLAVE 1 lights up.
3. Switch off photo cell:
Press push-button SLAVE until LEDs SLAVE 1, SLAVE 2 and SLAVE 3 go out.

Switch on, adjust and switch off of pre-flash suppression

1. Switch on device.
See Switching on and off of device.
2. Switch on device.
See Switching on and off of device.
3. Switch on photo cell:
Press push-button SLAVE.
LED SLAVE 1 lights up.
4. Switch on pre-flash suppression:

- Camera with 1 pre-flash:
Press push-button SLAVE until LED SLAVE 2 lights up.
 - Camera with 2 pre-flashes:
Press push-button SLAVE until LED SLAVE 3 lights up.
5. Switch off pre-flash suppression:
Press push-button SLAVE until LEDs SLAVE 2 and SLAVE 3 go out.

11. Mount on tripod (optional)

ADVICE:

Please note the user information of the tripod manufacturer.

⚠ CAUTION

Select a tripod of suitable weight and dimensions. See *Technical Specifications*.

Make sure, that the tripod with the mounted device has a tilt and skid resistant stand.

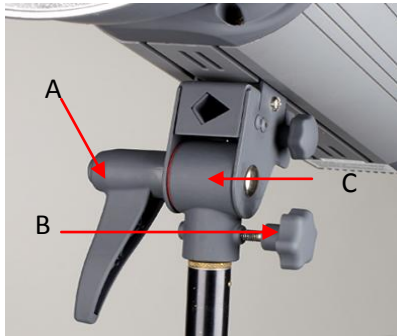

- A Locking lever
- B Locking knurl
- C Fixture

1. Loose locking lever.
2. Open locking knurl.
3. Mount the device on the tripod.
4. Tighten locking knurl.
5. Close locking lever.

12. Mount reflex umbrella (optional)

⚠ CAUTION

Just use reflex umbrellas with a rod diameter of 8-10mm.

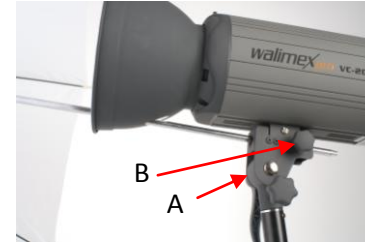

- A Fixture
- B Locking knurl

1. Let the device cool down.
⚠ WARNING! Danger of burning on reflector, modeling lamp and flash tube. Please cool down approx. 30 minutes.
2. Open locking knurl.
3. Insert the rod of the reflex umbrella through the opening in the reflector into the fixture as far as it will go.
4. Tighten locking knurl
ADVICE: Don't tighten the locking knurl too tight as to avoid damages on the reflex umbrella.

13. Switch on and off of modeling lamp

1. Switch on device.
See Switching on and off of device.
 11. Switch on modeling lamp:
Press control OUTPUT POWER once.
 - The modeling lamp switches on.
 - The LED MODEL ▲ lights up.
 12. Switch off modeling lamp:
Press control OUTPUT POWER twice.

- The modeling lamp goes out.
- The LED MODEL ▲ goes out.

ADVICE: If you don't switch off the modeling lamp before switching off the device, the modeling lamp will light up automatically, when switching on the device again.

14. Flash trigger

▲ WARNING

Fire danger through overheating.

Continuous rapid sequences of flashes from more than 8 flashes per minute with high flash output could overheat and damage the device.

Heat accumulation could be the result when using small, narrow reflectors (e.g. snoots) or grid reflectors at high power with the device pointing downwards.

Continuous increasing and decreasing of the flash output can heat up the device additionally.

- **Avoid continuous rapid sequences of flashes from more than 8 flashes per minute with high flash output.**
- **Don't use the device in vertical direction, when making rapid flash sequences and high flash output with a small, narrow reflector or grid reflector.**
- **Don't increase and decrease the output unnecessary.**

Note the following mentioned restrictions.

1. Switch on device.
See Switching on and off of device.
2. Modeling lamp is switched on or off according to requirements.
See Switch on and off of modeling lamp.
3. Trigger flash according to the prepared type of flash trigger.
See Prepare and adjust flash trigger.
 - Do not flash over 12 shots per minute for over 10 minutes.

- Do not flash over 10 shots per minute for over 30 minutes.
- Do not flash over 8 shots per minute for over 60 minutes.
- In the above mentioned cases, let the device cool down for at least 15 minutes.
 - Don't switch off the device during the 15 minutes cooling time as to avoid the interruption of the cooling.
 - Don't trigger a flash during the 15 minutes cooling time, neither with reduced flash output.
- Switch off the modeling lamp.
See Switch on and off of modeling lamp.
- When the buzzer of the overheating and overloading warning beeps: Reduce the flash output or flash sequence
If the beep don't stop:
Let the device cool down for at least 30 minutes:
 - Don't switch off the device during the 30 minutes cooling time as to avoid the interruption of the cooling.
 - Don't trigger a flash during the 30 minutes cooling time, neither with reduced flash output.
 - Switch off the modeling lamp.
See Switch on and off of modeling lamp.

15. Transportation and storage

1. Switch off device.
See Switching on and off of the device.
2. Cool down the device completely.
▲ WARNING! Fire danger through hot parts. Let the device cool down completely.
 13. Screw out modeling lamp:
 - Screw out the modeling bulb carefully.
 - Demount protection cap.
See Demount and mount protection cap.
 - Stick the safety cap onto the unlocking lever.

3. Demount reflector and all power and connecting cables.
4. Clean the device if necessary.
See *Cleaning*.
5. Put the device and all demounted elements into the original styrofoam packing and carry and store them according to the requirements in the technical specifications. See *Technical Specifications*.

16. Solve problems

Problem	Possible reason	Remedy
Flash device is switched on, but has no function	Power cord is not plugged or plugged incorrect	Plug in the power cord correctly
	Micro-fuse is defect	Change micro-fuse, see <i>Change micro-fuse</i>
Flash device has function, but flash trigger is not possible	Flash capacitor is defect	Contact our service department
Modeling lamp flickers	Modeling lamp is defect	Change modeling lamp, see <i>Screw in and out modeling bulb</i>

17. Maintenance

17.1. Continuous inspections

What you should do?	Before every operation	If necessary
Check all cables and plugs for damages. In case of damage: ⚠ WARNING! Danger of electric shock and fire through short-circuit The device should be repaired by an electrician immediately.	X	
Charge flash capacitor See <i>Charge of flash capacitor</i>		X

17.2. Cleaning

⚠ WARNING

Posterior danger of bursting of flash tube

Make sure not to touch the flash tube with bare hands accidentally.

⚠ WARNING

Danger of electric shock

- **Just use the specified cleaning supplies** The contact with moisture or water should be avoided
- **Disconnect from power supply during cleaning.**

Part of the device	Cleaning
Housing	Use a microfiber cloth to remove light and stubborn dirt.
Modeling bulb, flash tube	Wipe off with dust brush or dry, soft cloth <i>ADVICE:</i> <i>Don't clean the modeling bulb and flash tube with water. Even small residues on the bulbs could lead to bursting</i>
Reflector	Remove dirt with microfiber cloth

17.3. Change flash tube

⚠ WARNING

Please just use flash tubes, which are conform with the required specifications as to avoid the bursting of the flash tube. See *Technical Specifications*.

⚠ WARNING

Posterior danger of bursting of flash tube

Don't touch the flash tube with bare hands. Wear clean cotton gloves or use a clean cloth.

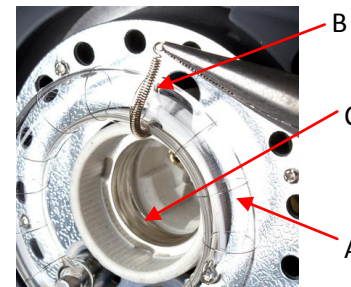

- A Flash tube
- B Retention clip
- C Socket for modeling lamp

1. Discharge device:
 - ⚠ WARNING!** Danger of electric shock. Discharge the device before changing the flash tube.
 - Switch on device.
See Switching on and off of the device.
 - Trigger flash:
Press push-button TEST and switch off main switch immediately.
ADVICE: If you don't switch off the main switch within 0.5 s, the device will charge anew.
 - Unplug power cord.
2. Cool down device.
 - ⚠ WARNING!** Danger of burning on reflector, modeling lamp and flash tube. Please cool down approx. 30 minutes.
3. Remove old flash tube:
 - Demount reflector.
See Demounting and mounting of reflector.
 - Screw out modeling lamp.
See Screw in and out of modeling lamp.
 - Hook off the retention clip with pliers.

- Hold the flash tube at the right and left side of the socket.
⚠ CAUTION! Danger of cutting and splitting through breaking flash tube. Just touch the flash tube in the range of the plug-in contact and not at the levitated flash ring.

- Agitate the flash tube carefully and pull out from the socket.

4. Attach the new flash tube:

- Place the two plug-in contacts of the flash tube loose into the socket.
- Press the flash tube with even, slight pressure on the plug-in contacts into the socket as far as it goes.

⚠ CAUTION! Danger of cutting and splitting through breaking flash tube. Put the pressure only on the range above the plug-in contacts and not on the levitated ring flash.

ADVICE:

Press the two plug-in contacts carefully and even into the socket as to avoid the deformation of the wires.

- Hook in the retention clip with pliers.
- Screw in modeling bulb.
See Screw in and out of modeling bulb.
- Mount reflector.
See Mount and demount reflector.

17.4. Change micro-fuse

⚠ WARNING

Danger of electric shock and fire through short-circuit

A micro-fuse, which is not conform with the required specifications, doesn't protect against the overloading of the device.

Please just use a micro-fuse, which is conform with the required specifications. See *Technical specifications*.

ADVICE:

The fuse holder keeps a spare fuse.

1. Switch off device.
See Switching on and off of device.

2. Disconnect from power supply:

Unplug power cord.

3. Open fuse holder:

Use a small screwdriver to lift up the fuse holder carefully and slightly.



A Fuse holder

1. Pull out the fuse holder with your hands completely out of the slot.

5. Take out the old micro-fuse.

6. Take the new micro-fuse out of the spare slot and slide it in the center of the holder.

7. Slide the fuse holder carefully into the slot as far as it goes.

17.5. Charge of flash capacitor

ADVICE:

Charge the flash capacitor completely,

- *when you have used the device several days mainly with reduced output*
- *when you didn't use the device for several months*

Thus, you can protect the life expectancy of your flash capacitor and ensure a continuous optimal power output.

1. Switch on device.

See Switching on and off of the device.

ADVICE:

The modeling lamp can remain switched off.

2. Adjust maximal flash output:

Turn control OUTPUT POWER until the digital display OUTPUT POWER shows the value 6.0.

3. The device should remain switched on at least 30 min.

4. Re-adjust the flash output on the desired value.

18. Accessories and options

You can find extensive accessories for your walimex pro studio flash in our webshop.

19. Spare parts

Part of the device	Order number
Flash Tube VC-200/300 until serial number 0903CH116304	15209
Flash Tube VC-200/300 start from serial number 0903CH116305	16296
Flash Tube VC-400/600 until serial number 0903CH116304	15210
Flash Tube VC-400/600 start from serial number 0903CH116305	16297
Flash Tube VC-800/1000 until serial number 0903CH116304	15211
Flash Tube VC-800/1000 start from serial number 0903CH116305	16298
Protectiion Cap VC series	15212
Modeling Lamp 150W / 230V	13109
Modeling Lamp 250 Watt / 230V	15206
Sync Cord 420cm with Phone Jack 6.3mm	12900
Standard Reflector VC&K&DS series matt	13119
Standard Reflector VC series glossy	16242
Power Cord 4m with IEC Connector	12914

20. Disposal and environment protection

Your device should be disposed free of charge at the local disposal points.

21. Technical specifications

	VC-200	VC-300	VC-400	VC-600	VC-800	VC-1000
Flash output	200 W	300 W	400 W	600 W	800 W	1000 W
Guide number (1m/ISO 100)	50	60	70	78	88	96
Output	Full to 1/16					
Recycling time	0,8 ~ 1,5 s	1 ~ 2 s	1 ~ 2 s	2 ~ 3 s	2 ~ 3 s	2 ~ 3 s
Flash duration	1/800 ~ 1/1200 sec.					
Modeling lamp	150 W			250 W		
Trigger method	Photo cell, sync cord, test button					
Colour temperature	5600 K ±200					
Flash tube	Plug-in, user replaceable					
Trigger voltage	5 V					
Cooling	Yes					
Automatic discharge	Yes					
Power source	AC 220 - 240 V / 50 Hz					
Accessories	Reflector, power cord (4 m), sync cord, modeling lamp, instruction manual					
Weight	2,5kg	2,5 kg		2,8 kg	3,3 kg	3,3kg
Dimensions (in cm, w/o reflector)	30 x 13 x 13	30 x 13 x 13		32 x 13 x 13	36 x 13 x 13	
Micro-fuse	6,3 A	6,3 A	6,3 A	6,3 A	6,3 A	6,3 A
Permitted operation temperature	-10 °C bis + 40 °C					
Storage conditions	Dry and dust-free in the original packing at -20 °C bis +50 °C					
Specifications flash tube(order number) until serial number 0903CH116304						
	15209	15209	15210	15210	15211	15211
Specifications flash tube(order number) start from serial number 0903CH116305						
	16296	16296	16297	16297	16298	16298

22. Overview about the operation panel



A	Digital display OUTPUT POWER	J	LED MODEL I
B	Push-button SLAVE	K	LED MODEL II
C	LED SLAVE 1	L	LED AUDIO
D	LED SLAVE 2	M	LED TEST
E	LED SLAVE 3	N	Control OUTPUT POWER
F	Push-button MODEL ▼	O	Main switch O/I (OFF/ON)
G	Push-button MODEL ▲	P	Connecting socket for sync cord
H	Push-button AUDIO	Q	Fuse holder
I	Push-button TEST	R	Socket for power cord

22.1. Overview about the funktion on operating controls

A	Digital display OUTPUT POWER	Indicates the output of the modeling lamp and the value for the flash output
B	Push-button SLAVE	Switch on and off for photo cell Switch off of pre-flash suppression for 1 pre-flash Switch off of pre-flash suppression for 2 pre-flashes
C	LED SLAVE 1	Lit, when photo cell is switched on
D	LED SLAVE 2	Lit, when pre-flash suppression for 1 pre-flash is switched on
E	LED SLAVE 3	Lit, when pre-flash suppression for 2 pre-flashes is switched on
F	Push-button MODEL ▼	Reduces modeling light
G	Push-button MODEL ▲	Increases modeling light
H	Push-button AUDIO	Switch-on for acoustic beeper button
I	Push-button TEST	Triggers test flash
J	LED MODEL I	Lit, when modeling light is adjusted independent from flash output
K	LED MODEL II	Lit, when modeling light is adjusted depending on flash output
L	LED AUDIO	Lit, when the acoustic beeper button is switched on
M	LED TEST	Lit, when the appointed flash output is reached (flash is ready for use)
N	Control OUTPUT POWER	Adjusting the modeling light and flash output
O	Main power switch O/I (OFF/ON)	Switches the flash on and off
P	Connection socket for sync cord	Connection socket for sync cord or remote receiver (optional)
Q	Fuse holder	Contains the microfuse and spare fuse
R	Socket for power connection	Connection for external power supply